

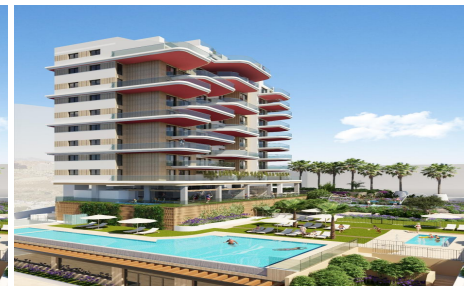

## 2 bedroom Apartment in Calpe

Ref: sh 2372

319,000 €

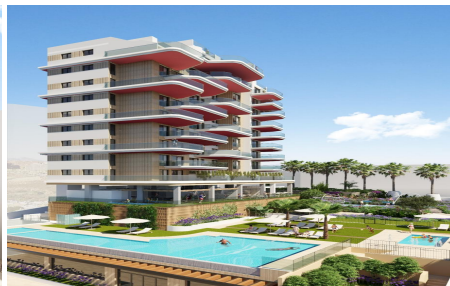

<b>Sales type :</b>	New build	<b>Swimming pool :</b>	Communal	<b>House area :</b>	112 m <sup>2</sup>
<b>Year built :</b>	2026	<b>Garden :</b>	Communal	<b>Terraces area :</b>	16 m <sup>2</sup>
<b>Energy certificate :</b>	X	<b>Orientation :</b>	South East		
<b>Bedrooms :</b>	2	<b>Views :</b>	sea and mountain view		
<b>Bathrooms :</b>	2				

- |                                                             |                                                      |                                                      |                                                           |
|-------------------------------------------------------------|------------------------------------------------------|------------------------------------------------------|-----------------------------------------------------------|
| <input checked="" type="checkbox"/> Air conditioning        | <input checked="" type="checkbox"/> Central heating  | <input checked="" type="checkbox"/> Fitted wardrobes | <input checked="" type="checkbox"/> Terrace               |
| <input checked="" type="checkbox"/> Elevator                | <input checked="" type="checkbox"/> Garage           | <input checked="" type="checkbox"/> Jacuzzi          | <input checked="" type="checkbox"/> double glazed windows |
| <input checked="" type="checkbox"/> ensuite bathroom        | <input checked="" type="checkbox"/> rental potential | <input checked="" type="checkbox"/> granite worktops | <input checked="" type="checkbox"/> residential complex   |
| <input checked="" type="checkbox"/> Roller blinds or blinds | <input checked="" type="checkbox"/> Gymnasium        | <input checked="" type="checkbox"/> solar power      | <input checked="" type="checkbox"/> Accessible            |
| <input checked="" type="checkbox"/> wifi internet           |                                                      |                                                      |                                                           |

Modern construction of 10 floors in Calpe, consisting of 2 and 3 bedroom flats. In front of the Oppenheim park, only 8 minutes walking distance to the Manzanera cove. In the communal areas: - Panoramic swimming pool with infinity edge and swimming lane with saline chlorination and night lighting. saline chlorination and night lighting. - Integrated heated Jacuzzi. - Showers and...